

PVC CEMENT

Function

Provide bonding between Tigre PVC pipes and connections by means of cold welding

Application

Welding procedure of Brown Weldable lines for Cold Water, DWV (drain, waste, vent), electrical conduit, irrigation and sewer / drain applications.



1. TECHNICAL DATA

- PRODUCT 1104MB.
- SIZES: 1 quart, 1 pint, 1/2 pint and 1/4 pint.
- COLOR: clear
- DENSITY: 7.6 lb/gal.
- SET TIME: fast.
- MAX VOC PER SCAQMD 1168/316A: 510 G/L.
- HYDROSTATIC PRESSURE TEST: 400 psi min. (73° F, 2 hour cure).
- FLASH POINT: -4° F (closed cup).
- SHELF LIFE: 3 year minimum

1.1 REFERENCE ESPECIFICACIONES

- ASTM D 2564, SCAQMD 1168/316^a

LISTINGS:

- NSF (National Sanitation Foundation) 
- U.P. Code (Uniform Plumbing Code)

1.2 COMPLEMENTARY ITEMS

- DWV line
- SDR35 Line
- SCH40 PVC Line

2. BENEFITS

- Product easy to apply: There is no need of special tools; using a brush or the adhesive own applicator nozzle is enough;
- Perfect water tightness: Cold welding procedure provides chemical reaction that bonds surfaces under contact, making then a sole material.

3. INSTALACIÓN

3.1 Instructions for Application:

Joining system between pipes and connections is carried out through 'cold welding', i.e., just applying Cleaner and, following, the PVC Cement to carry out the material welding. Water tightness assurance is exactly the process of making parts to become a single set, provided by welding with adhesive.

Procedure for welding with Cleaner and PVC Cement:

Step 1: Sand the surfaces to be welded using sandpaper 100. Test the fitting between parts that shall be very tight, almost impossible without the adhesive, as without pressure welding does not set.

Data Sheet



Note: When cutting the pipe, remove sharp edges and bevel the tip, to enable connections fitting.

Step 2: Clean the surfaces sanded with TIGRE Cleaner, removing impurities and fats.



Step 3: Evenly spread the PVC Cement in bags and on the tips to be welded (with the brush or with the tube own nozzle).

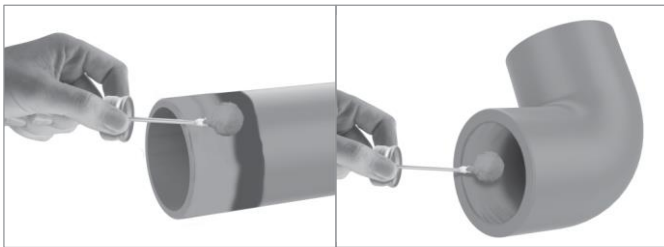

Step 4: Fit all at ones the ends to be welded, providing a slight rotation movement between parts (back and forth) till achieving the definite position. Remove adhesive excess

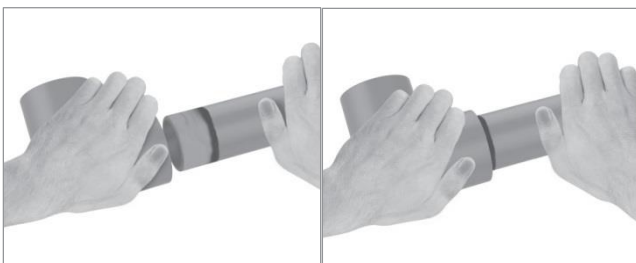

Wait for 1 hour to fill the piping with water and 12 hours to perform the pressure test.

3.2 Transportation / Handling

During danger products transportation, the carrier shall:

Make available driver skilled to this type of transportation (Mopp course)

Make safety kit, plates with symbology and risk number available;

Guide drivers to carefully read the safety envelope and the emergency file (both provided by Tigre) before starting the journey so, in case of accidents, they proceed according to their instructions.

IMPORTANT: These rules apply to vehicles that transport load above 333 kilograms of products mentioned in this technical sheet. Information reinforced in case of load manifest.

Personal Protection Equipment:

Breathing protection: mask with filter to protect from organic vapors.

Hands protection: Rubber, Latex / Neoprene gloves/ or other ones resistant to organic solvents.

Eyes protection: Safety goggles for chemicals.

Skin and body protection: PVC apron, safety footwear and others according to the work conditions.

Special precautions: according to the work conditions.

3.3 Package / Storage:

- Store in sheltered, cool, dry and ventilated areas;
- Do not step on the products;
- Do not store the products in places with explosive materials, flammable and/or toxic gases, corrosive, oxidizing substances (Liquid Chlorine and Concentrated Oxygen) organic peroxides, spontaneous combustion materials and radioactive materials;
- Handle the product in cool and ventilated area;
- Do not reuse the package;
- If there is leakage or spilling in closed environments, exhaust and ventilation shall be provided.

Data Sheet

3.4 Maintenance and Care:

Preventing from inhalation, contact with skin and eyes:

- Avoid inhaling adhesive vapors.
- Avoid contact with skin, mucous membranes and eyes.
- After the work, wash hands with water and soap.

First Aid Measures:

- **Inhalation:** Remove the victim to cool and ventilated area, keeping him/her warm and at rest. If breathing is irregular or stops, apply assisted breathing technique (mouth-to-mouth ventilation, observing that when filling the mouth, chest shall elevate, featuring full lung).

Do not give any oral substance to the victim, if unconscious; consciousness shall be reestablished as well as seeking for medical care.

- **Contact with the skin:** Remove contaminated clothes and wash immediately with plenty of water. Seek medical care if irritation or other symptoms are present.
- **Contact with the eyes:** If the victim is using contact lenses, they shall be removed. Wash with plenty water for 15 minutes with the eyelid inverted; check eyes movement to all directions. If the victim does not tolerate direct light, cover the eye. Seek ophthalmologist care.
- **Intake:** Do not induce vomit; maintain the person at rest. Seek medical care.

4. LINE ITEMS

PVC CEMENT - Clear



CODE	SIZES	Primary quantity	Secondary quantity
37000008	1/4 PINT (4 FL. OZ.) 118mL	1	24
37000009	1/2 PINT (8 FL. OZ.) 237mL	1	24
37000010	1 PINT (16 FL. OZ.) 473mL	1	12
37000011	1 QUART (32 FL. OZ.) 946mL	1	12